



## **ALL BREEDS ALL BRITAIN CALF SHOW 2018**

Friday 19<sup>th</sup> – Sunday 21<sup>st</sup> October

East of England Showground, Peterborough, PE2 6HE

### **COLOURED BREEDS SCHEDULE**

***ENTRIES RECEIVED AFTER FRIDAY 28<sup>th</sup> SEPTEMBER 2018 WILL NOT BE CONSIDERED***

#### **SHOW DIRECTOR**

Mr Edward Griffiths

#### **SHOW MANAGERS**

Mrs Miriam Bagley  
Mrs Hannah Williams

#### **COLOURED BREEDS COORDINATORS**

Mr Duncan Hunter  
Ms Nicola Dean  
Ms Kirsten Bevis

#### **COLOURED BREEDS CHIEF STEWARD**

*Mr Duncan Hunter*

## TIMETABLE

### **FRIDAY 19<sup>TH</sup> OCTOBER**

- 12:00 – 22:00 Calves may arrive on site. Please note that all calves **must** arrive no later than 22:00. Those requiring entry prior to 12:00 due to transport must apply beforehand
- 19:00 – 19:30 Holstein showmanship demonstration
- 19:30 – 20:00 Coloured breeds showmanship demonstration

### **SATURDAY 20<sup>TH</sup> OCTOBER**

- 10:00 Stand building to be completed before showmanship classes commence
- 10:00 Holstein & coloured breeds showmanship classes commence
- 20:30 – 00:00 Young Breeders Celebration

### **SUNDAY 21<sup>ST</sup> OCTOBER**

- 08:30 Coloured breeds calf classes commence
- 10:00 Holstein calf classes commence followed by coloured breeds & Holstein championships
- 14:30 Champions from all breeds will parade at the end of the breed championships
- 15:00 Presentations
- 16:00 Calves depart

# VENUE

## Address

East of England Showground, Oundle Road, Peterborough, Cambridgeshire, PE2 6HE

Please ensure that you use the postcode provided above, **not** the postcode you will find on the internet. The postcode provided above will bring you into the Showground via the correct entrance for the event.

## Showground

Please follow external & internal signage, which will direct you to the calf drop-off, parking & camping areas.

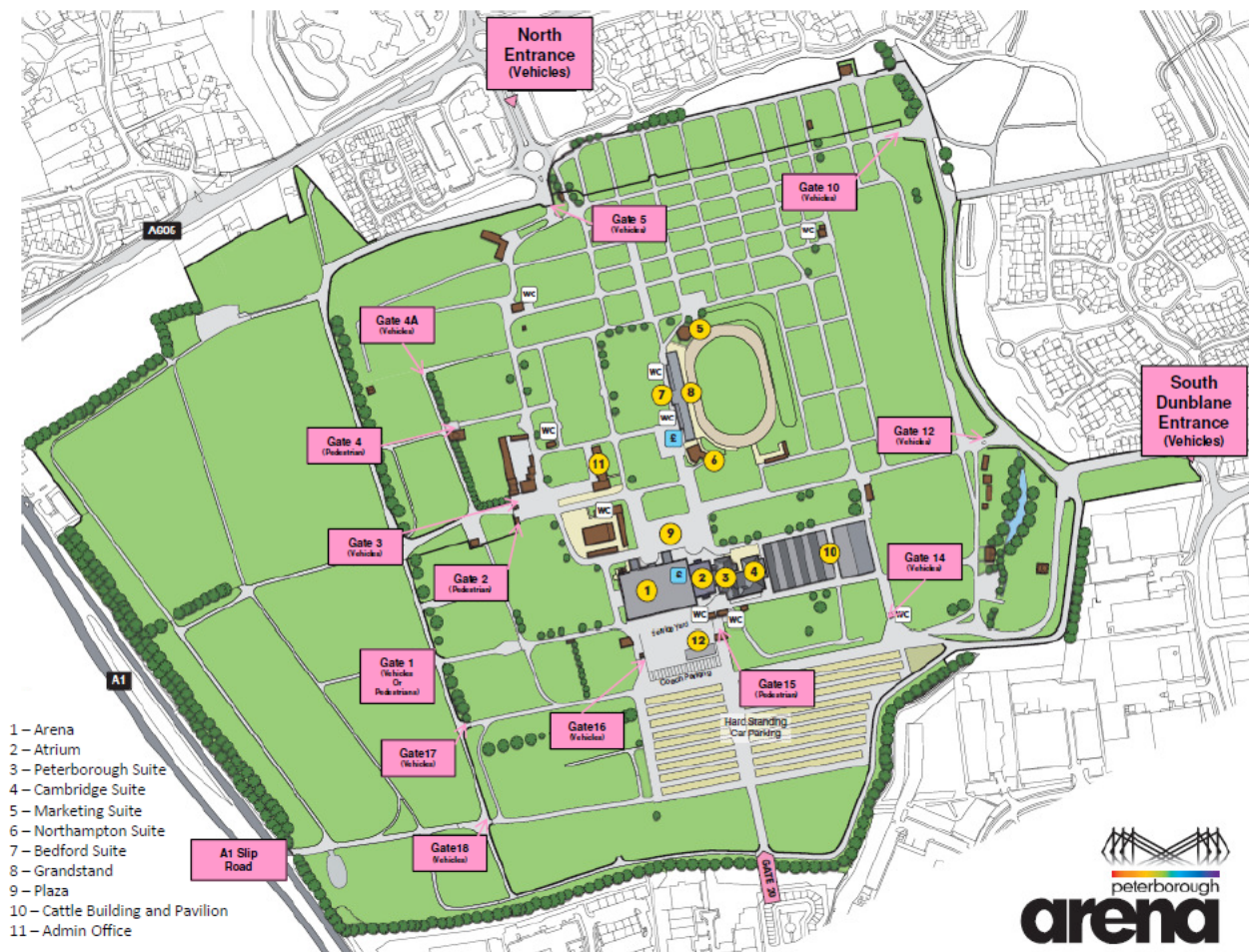

## Cattle Building

Cattle lines, clipping bays & collecting ring

## The Pavilion

Holstein & coloured breeds rings

## Northampton Suite

Littlestar interviews & Coordinators Meeting

## Cambridge Suite

Young Breeders Celebration

## Catering

Breakfast & lunch – catering van outside Cattle Shed

Evening meal & bar – Cambridge Suite

## **SHOWMANSHIP CLASSES**

*Judge: Mr Ben Yates*

*Steward(s): Mr Duncan Hunter, Ms Kirsten Bevis, Mr Ben Etteridge and Ms Nicola Dean*

Class 1 Junior	Aged 12 years & under on 1 <sup>st</sup> January 2018
Class 3 Intermediate	Aged between 13 & 15 years on 1 <sup>st</sup> January 2018
Class 5 Senior	Aged between 16 & 20 years on 1 <sup>st</sup> January 2018
Class 7 Mature	Aged between 21 & 26 years on 1 <sup>st</sup> January 2018

**GRAHMAR TROPHY:** Champion Jersey Showman

**WRIGHT MANLEY TROPHY:** Champion Ayrshire Showman

**FRANK R MARSHALL TROPHY:** Champion Shorthorn Showman

**HILTON BROOKS PERPETUAL CHALLENGE CUP:** Champion Guernsey Showman

**BRITISH FRIESIAN CHAMPION HANDLER TROPHY:** Champion British Friesian Showman

**BROWN SWISS TROPHY:** Champion Brown Swiss Showman

## **CALF CLASSES**

### **JERSEY CALF CLASSES - ENTRIES £10 PER STALL**

*Judge: Ms Sarah Pye*

*Steward(s): Mr Mark Logan and Mr Barry Daw*

Class 16	Born on or after 1 <sup>st</sup> March 2018
Class 22	Born between 1 <sup>st</sup> December 2017 & 28 <sup>th</sup> February 2018
Class 28	Born between 1 <sup>st</sup> September & 30 <sup>th</sup> November 2017
Class 34	Born between 1 <sup>st</sup> May & 31 <sup>st</sup> August 2017
Class 40	Born between 1 <sup>st</sup> January & 30 <sup>th</sup> April 2017

Rosettes will be presented 1<sup>st</sup> - 6<sup>th</sup>

**BLUEGRASS TROPHY:** Champion Jersey Calf

---

### **AYRSHIRE CALF CLASSES - ENTRIES £10 PER STALL**

*Judge: Mr Ian Collins*

*Steward(s): Mr Duncan Hunter and Mrs Elaine Berresford*

Class 17	Born on or after 1 <sup>st</sup> March 2018
Class 23	Born between 1 <sup>st</sup> December 2017 & 28 <sup>th</sup> February 2018
Class 29	Born between 1 <sup>st</sup> September & 30 <sup>th</sup> November 2017
Class 35	Born between 1 <sup>st</sup> May & 31 <sup>st</sup> August 2017
Class 41	Born between 1 <sup>st</sup> January & 30 <sup>th</sup> April 2017

Rosettes will be presented 1<sup>st</sup> - 6<sup>th</sup>

**WHITEFORD FAMILY TROPHY:** Champion Ayrshire Calf

---

### **DAIRY SHORTHORN CALF CLASSES - ENTRIES £10 PER STALL**

*Judge: Mr Matt Hayward*

*Steward(s): Mrs Mary Collins and Mr Gwendaff James*

Class 18	Born on or after 1 <sup>st</sup> March 2018
Class 24	Born between 1 <sup>st</sup> December 2017 & 28 <sup>th</sup> February 2018

Class 30 Born between 1<sup>st</sup> September & 30<sup>th</sup> November 2017  
Class 36 Born between 1<sup>st</sup> May & 31<sup>st</sup> August 2017  
Class 42 Born between 1<sup>st</sup> January & 30<sup>th</sup> April 2017

Rosettes will be presented 1<sup>st</sup> – 6<sup>th</sup>

**THE CHURCHROYD TROPHY:** Champion Dairy Shorthorn Calf

---

### **GUERNSEY CALF CLASSES - ENTRIES £10 PER STALL**

*Judge: Mr Colin Evans*

*Steward(s): Ms Laura Barnes and Ms Caroline Huins*

Class 19 Born on or after 1<sup>st</sup> March 2018  
Class 25 Born between 1<sup>st</sup> December 2017 & 28<sup>th</sup> February 2018  
Class 31 Born between 1<sup>st</sup> September & 30<sup>th</sup> November 2017  
Class 37 Born between 1<sup>st</sup> May & 31<sup>st</sup> August 2017  
Class 43 Born between 1<sup>st</sup> January & 30<sup>th</sup> April 2017

Rosettes will be presented 1<sup>st</sup> – 6<sup>th</sup>

**SNOWHILL CHALLENGE TROPHY:** Champion Guernsey Calf

---

### **BROWN SWISS CALF CLASSES - ENTRIES £10 PER STALL**

*Judge: Mr Daniel Kung*

*Steward(s): Mr Jonny Lothead and Mr Mark Williams*

Class 20 Born on or after 1<sup>st</sup> March 2018  
Class 26 Born between 1<sup>st</sup> December 2017 & 28<sup>th</sup> February 2018  
Class 32 Born between 1<sup>st</sup> September & 30<sup>th</sup> November 2017  
Class 38 Born between 1<sup>st</sup> May & 31<sup>st</sup> August 2017  
Class 44 Born between 1<sup>st</sup> January & 30<sup>th</sup> April 2017

Rosettes will be presented 1<sup>st</sup> - 6<sup>th</sup>

**BROWN SWISS TROPHY:** Champion Brown Swiss Calf

---

### **BRITISH FRIESIAN CALF CLASSES**

*Judge: Mr Murray Cochran*

*Steward(s): Mr Andrew Spicer*

Class 21 Born on or after 1<sup>st</sup> March 2018  
Class 27 Born between 1<sup>st</sup> December 2017 & 28<sup>th</sup> February 2018  
Class 33 Born between 1<sup>st</sup> September & 30<sup>th</sup> November 2017  
Class 39 Born between 1<sup>st</sup> May & 31<sup>st</sup> August 2017  
Class 45 Born between 1<sup>st</sup> January & 30<sup>th</sup> April 2017

Rosettes will be presented to 1<sup>st</sup> - 6<sup>th</sup>

**THE JACKSON TROPHY:** Champion British Friesian Calf

---

## **IMPORTANT INFORMATION**

### **Water**

There are approximately 25 taps available to exhibitors. These are located between the Cattle Shed & the Pavilion, as well as at the far ends of the two buildings. Clubs must bring their own hoses, if required, as these will not be provided.

### **Straw**

An allocation of Straw will be provided free of charge. Shavings and additional straw can be brought to the event but will not be available to purchase.

### **Arrival & Departures**

Passports **must** be brought to the event & will be checked by the stewards. All animals attending the event **must** be accompanied by a pre-movement TB test certificate, regardless of the location of the holding they are travelling from. Paperwork **must** accompany the animals & be presented to the stewards. **Any calf unsatisfactorily identified at the event will not be allowed to participate.** All calves must have both primary & secondary ear tags in accordance with DEFRA regulations. **Any animal without double tags will not be allowed to enter the showground.** Please note, all animals must be registered with the relevant breed Society.

All calves **must** arrive on site by 22:00 on Friday. Late arrivals will not be permitted. Departure must not be earlier than 16:00 on Sunday, directly after the final presentations. **No early departures will be permitted:** please ensure all haulers are aware of this.

### **Liability**

Holstein UK cannot accept any liability for loss of or damage to property, persons or livestock. It is the responsibility of each individual to ensure that adequate insurance cover & security measures are taken. No lorries or cattle trailers are permitted to park in the cattle sheds due to fire regulations.

### **Clipping & Preparation**

At the event, any clipping or preparation of calves **must** be done by either a member under 30 years old or the owner of calf.

### **Electrical/cooking equipment**

Health & safety regulations do not allow the use of any electrical or cooking equipment in the cattle lines. Kettles may be used (but not urns) in the designated kitchen areas; they **must** be placed on a solid surface & cables **must not** create a trip hazard. This **must** be strictly adhered to. A communal kitchen area will be provided at either end of the Cattle Shed. We ask everybody to please make use of these communal areas.

All electrical equipment **must** be PAT tested & in line with IEE regulations, paragraph 7.6.2.

### **Faking**

Any faking that is seen to take place, either by competitors or persons assisting in the preparation of the calves, will lead to disqualification from the competition. Doping of calves at the final is **not** permitted & any person seen doing so, or suspected of doing so, will be disqualified. Any injection to an animal must be reported to the stewards prior to administration. False hair in toplines is not permitted.

## **ACCOMMODATION**

### **Caravans & camping**

There are facilities for caravans & tents at the Showground, including showering facilities. Please contact Miriam Bagley at [miriambagley@holstein-uk.org](mailto:miriambagley@holstein-uk.org) to book a caravan/tent pitch & electric hook-up (if required), allocated on a first come first served basis. There will be no charge for a caravan/tent pitch. **However, there will be a £40 one-off charge for electric hook-ups (to cover Friday & Saturday nights).** This will be paid to the Showground by Holstein UK & charged to your exhibitor account by the Society. **This means you must provide a breed & prefix at the time of booking to secure your hook-up.** Hook-ups will be labelled for exhibitors on arrival; please ensure you use the hook-up(s) you have booked & been allocated. Strictly no vehicles or caravans are allowed in the cattle sheds.

### **Local Hotels**

#### **2\* Travelodge Peterborough Alwalton (3.3mi)**

Address: A1 Southbound, Alwalton, Peterborough, PE7 3UG

Tel: 08719 846003

Web: <https://www.travelodge.co.uk/>

#### **3\* Orton Hall Hotel (2.4mi)**

Address: The Village, Orton Longueville, PE2 7DN

Tel: 01733 391111

Web: <https://www.bestwestern.co.uk/>

#### **3\* Holiday Inn Express (onsite)**

Address: East of England Way, Orton Northgate, PE2 6HE

Tel: 0871 9021549

Web: <https://www.ihg.com/holidayinnexpress/hotels/gb/en/reservation>

**4\* Marriott Hotel (0.3mi)**

Address: Peterborough Business Park, Lynch Wood, PE2 6GB

Tel: 01733 371111

Web: <http://www.marriott.com/default.mi>

## RULES

1. Each entrant must be a fully paid up member of the relevant Society.
2. Only competitors may lead the calves in the showmanship & calf classes; no assistance will be allowed.
3. In the calf classes, calves must be handled by members of 26 years of age or under on 1<sup>st</sup> January 2018. For the last two classes of each breed, calves may be handled by anyone 30 years or under on 1<sup>st</sup> January 2018.
4. Each breed will be shown under their own Society's rules.
5. A calf may **not** be shown in more than one handler class.
6. All competitors are required to wear the relevant Society's showing uniform. Entry will be refused if competitors are not wearing the correct uniform.
7. Show officials have the right to refuse entry to any competitors who are late for their class.
8. Once at the Show any clipping or preparation of calves must only be done by the owner of the calf or a member aged 30 years of age or under.
9. No substitutes or late entries will be permitted.
10. Animals will undergo clinical inspection by the attending veterinary surgeon before entering the housing area. All certification must be presented to the attending veterinary surgeon on unloading.
11. The correct pedigree certificate & passport **must** accompany all animals.
12. Any animal with active ringworm will not be allowed into the show. Ringworm is defined as active if there is no hair re-growth. A written statement from your veterinary surgeon stating that the animal is undergoing treatment is required in these circumstances. We strongly recommend the use of Ringvac under veterinary guidance before the show, due to the high risk of ringworm transmission.
13. All animals attending the event **must** be accompanied by a pre-movement TB test certificate, regardless of the location of the holding they are travelling from. Paper work **must** accompany each animal & be presented to the stewards.
14. It is recommended that animals have certification of a negative BVD antigen screen.
15. No animal previously or currently owned or bred by the judge (as stated in the schedule) is permitted to be shown.
16. Non-payment of veterinary costs at the Show may result in suspension from future shows; as such, payment must be made direct to the veterinary practice as requested.



## CODE OF CONDUCT

1. The Show committee expects all competitors to behave in a responsible & appropriate way throughout the event. Inappropriate behavior will **not** be tolerated.
2. The actions of individuals are held accountable by their relevant breed Society. The Show committee reserves the right to disqualify exhibitors or members if they bring the reputation of the Society into question.
3. All competitors will be issued with wristbands to distinguish between under & over 18's, with no alcohol being served to under 18's. Wristbands for bar access & access to the Young Breeders Celebration will be handed out by the stewards on arrival or may be collected from the Show Office. Proof of identification will be required without exception.
4. No alcohol will be allowed in the cattle lines for the duration of the event; stewards reserve the right to confiscate any alcohol found.
5. Any one person found causing damage to property, persons or livestock will be immediately banned from taking part in the event & will be financially liable for any damages.
6. Anyone under 18 who is not accompanied by a parent/guardian will require a parental consent form, which **must** be signed by a parent/guardian & returned **prior to the event.**
7. Anyone under 16 should, ideally, be accompanied by a parent/guardian at events where an overnight stay is required.